

BRM Lasers

Delivery information

BRM Slim



Ideal for
creative use
and!

Contents

Specifications

Machine dimensions and weight

3

Placing the machine

Measuring out the route

Straight through a door

Measuring the passageway

When is a moving company needed?

Connecting the machine

Electricity

Computer: connection

Computer: specifications

Extraction

Air supply

4

Support and safety

Remote support

On-site support

Safety

Fire safety

Fire extinguishers

Laser safety

11

Annexes

Checklist for the installation route

Location checklist

12

Specifications

Machine dimensions and weight

(Dimensions in mm)	600	900	1300	1600
w	1370	1720	1970	2160
D	1010	1210	1510	1610
H	1320	1320	1320	1320
Weight (kg)	200	250	350	425

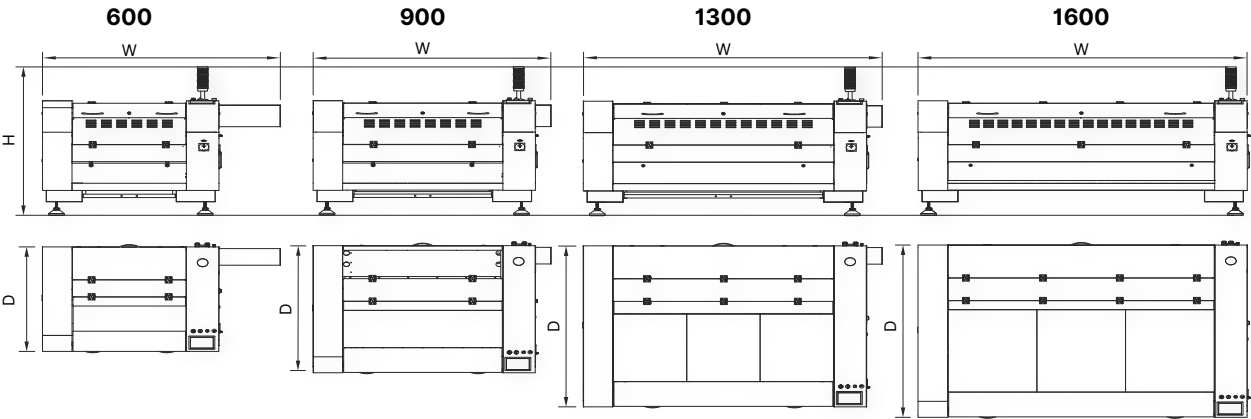

Feet

- Quantity: 4 adjustable feet
- Surface area of foot: \varnothing 80 mm

Placing the machine

When the machine is in use, no space is required at the left or rear. The following minimum space is required for maintenance or repair:

(Dimensions in mm)	600	900	1300	1600
BACK	500*	500*	500*	500*
LEFT	500*	500*	500*	500*
FRONT	900	1100	1400	1500
RIGHT	500	500	650	700

* May be 0 if the required free space can be created during maintenance or repair.

Measuring out the route

Straight through a door

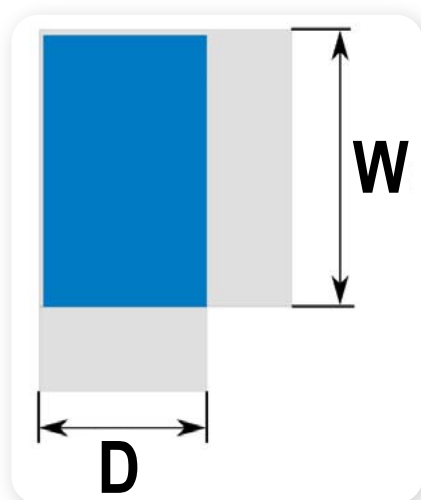

(Dimensions in mm)	600	900	1300	1600
W	1475	1750	2000	2250
D	1050	1250	1525	1625

As an option and for a surcharge, the machine can be split up and turned on its side. In that case, the dimensions below can be followed.

(Dimensions in mm)	600	900	1300	1600
W	1475	1650	1950	2250
D	800	800	800	800

Placing the machine

Measuring the passageway

When measuring a passageway, it is important to measure the correct smallest dimension. That is:

- The inside dimension of the door frame, if the door can be opened completely
- The measurement up to any protruding hinges
- The measurement up to the door, if it cannot be opened completely

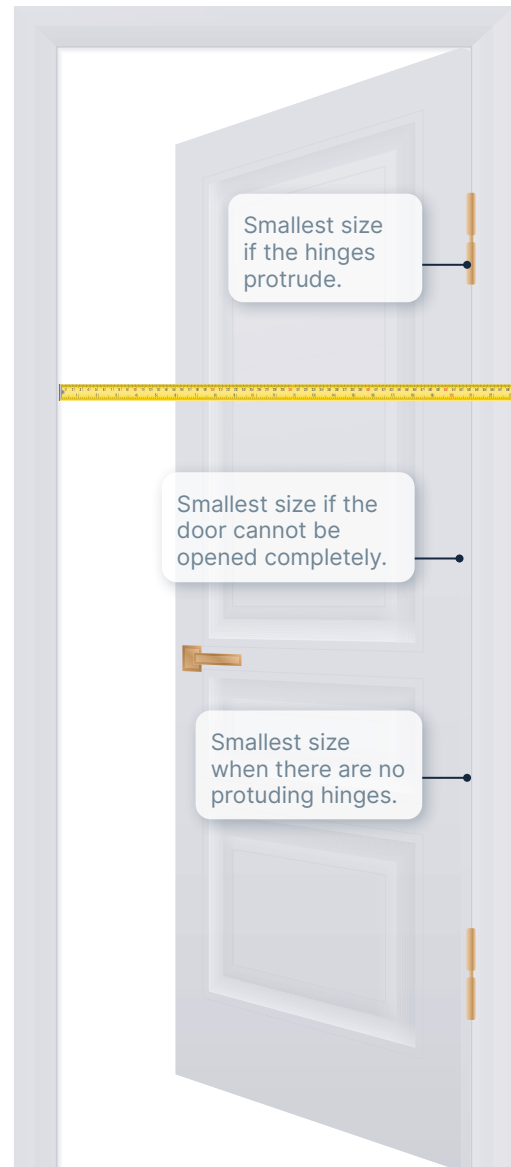

Placing the machine

When is a moving company needed?

Does the machine need to be lifted more than 100 mm? Then a moving company is needed for the installation. That can be the case when the machine needs to be lifted through a frame or when there is an elevation of more than 100 mm.

A moving company is also required when the machine will be transported up or down a ramp that:

- Is steeper than 5°
- Is narrower than the depth of your machine. See page 3.
- Is split
- Has tight turning radiusus

The following ramps require a moving company.



Split ramp



Sharp turning corners in driveway ramp

The following ramps do not require a moving company.



Connecting the machine

Electricity

The machine has two plugs to provide power to the machine.

The first plug is for the laser machine itself. The second plug is for the peripheral equipment, if you want to switch these on or off via the laser machine. You use these for the:

- Non-filtering fume extractor
- Air pump
- Water chiller

Both plugs are fused at 10 amps and cannot be connected to the same group as this would overload the electrical circuit.

Requirements for the power supply on site:

- Two grounded outlets. Type E or F
- Minimum of 10 amps left per outlet, minimum of 20 amps in total
- Due to certification, connecting to a type C, D, H or K is not allowed
- If you are using a BRM Extractor please inquire about other requirements



Permitted: E and F

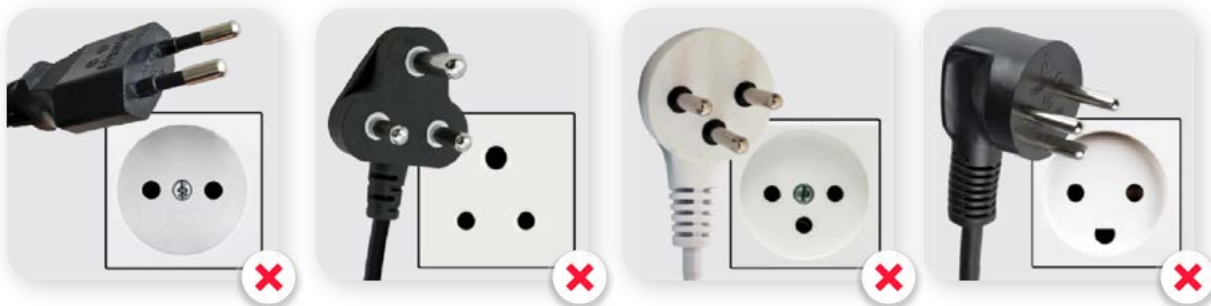

Not permitted: C, D, H, K and others

Placing the machine

Computer: connection

The machine can be connected with a USB 2.0 A connector (Windows only) or with a RJ45 UTP connector on 100 Mbit duplex.



USB-A

- Maximum length of USB cable: 3 metres
- Connection via USB hub is not recommended



RJ45

- Maximum length of network cable: 100 metres
- The network connection is not DHCP-compatible

Computer: specifications

The computer must meet the following minimum specifications:

- Windows 10 or later or MacOS X or later.
- When installing the software, one-time admin rights are required.

The following applies to every computer:

- At least a 800 MHz processor
- At least 2 GB working memory
- At least 500 MB storage

Extraction

1



A correct extraction of fumes is necessary. At the back of the machine is a connection (1) with an external diameter of 145 mm. A non-filtering exhaust with 2 pieces of hose is supplied as standard.

Check with the local regulatory authority whether exhaust gases may actually be discharged to the outside. If this is not allowed, a BRM Extractor is a solution.

It is also possible to use a company's own extraction solution. Several machines are often connected to this. This can create dangerous situations if sparks or burning particles are released. This is why we recommend installing a spark arrester when using a proprietary extraction solution to which several machines are connected. This is an excellent measure to cover a small risk with large consequences.

The required capacity for each model is listed below:

	600	900	1300	1600
m ³	380	380	550	850
mbar	15	15	15	15

Air supply

The machine comes standard with an air pump. This allows you to add air during cutting and engraving to prevent flame formation. With acrylic, the right amount of air can create nice smooth edges while cutting and with wood you can prevent some soot formation.

Next, air is essential for preserving your lens. The addition of air ensures that the fumes have less chance of settling on the lens.

The standard air pump included is connected to the machine with a silicone hose. Furthermore, it can be plugged into the socket of the machine.

Optional software-controlled air supply unit

With the optional software-controlled air supply unit the machine can be connected to a central system. The machine will get its own shut-off valve, conditioning and pressure regulator. In addition, PU hose (8 mm external, 6 mm internal) will be supplied. With this hose, the machine is connected to the push-in fitting that must be present in the central system. The maximum pressure that can be connected to the machine is 8 bar. Furthermore, the compressor should provide 120 l/ minute.

For materials where a lot of soot forms during cutting, you can make nicer cuts with more air. The edges become less black and do not give off. That saves post-processing.



8 mm PU hose



8 mm push-in fitting

Support and safety

Remote support

Using remote support, we help you quickly and efficiently. The following is required to be able to do this properly:

- A computer with an internet connection with at least 2 Mbps speed and 1.5 GB data cap per login.
- Administrator rights for the user of the computer that controls the machine.
- Administrator rights for our remote support software.

The remote support is performed with [ConnectWise Control software](#). This software must be installed just before remote support and is automatically uninstalled as soon as the session ends. The Privacy Statement can be read here: [privacy policy](#).

On-site support

Is on-site support needed? Then make sure there is enough space around the machine before the BRM mechanic arrives. Because the sooner our mechanic can get to work, the sooner the machine will be up and running again! Specifications for the space requirements can be found in the chapter '[Placing the machine](#)' on page 4.

Safety

Define the possible risks in your organization's health and safety policy.

Fire safety

Where the machine itself has a low risk of fire, more complex operations or incorrect settings can nevertheless create a high risk of fire. For this reason, BRM's standard rule is that the operator must always be near the machine when it is on.

In case of a potential fire, the fire class depends on the material used. Give employees and the fire prevention service the right information and provide the right measures and extinguishers.

Fire extinguishers

A laser machine has electrical components. Therefore, there are specific requirements for extinguishing agents. We recommend a CO₂ extinguisher. This is the best solution for an electrical fire. CO₂ quickly and effectively expels oxygen and suffocates the fire. Furthermore, CO₂ is very clean and the chance of collateral damage is smaller.

Less suitable or even unsuitable are:

- The powder extinguisher (ABC extinguisher) is not recommended. As extinguishing powder can cause a great deal of collateral damage, repairing the machine may be considerably more expensive or impossible.
- A fire blanket is only suitable if it is large enough to cover the machine to the ground.
- The foam extinguisher is not allowed according to NEN 2559. This is because voltages of over 1000V may exist within the machine.

Laser safety

The machine is laser class 1 certified. Laser safety is therefore guaranteed during normal use.

Of course, it is not permitted to bypass or sabotage safety. BRM is not responsible for safety in case of improper use.

Annexes

Checklist for the installation route

1. The minimum size for the parking place on delivery is 14 x 4,5 meters.

☐ Yes

☐ No, a different size _____

2. How many meters is it from the parking place to the space where the machine is to be installed?

_____ meters inside

_____ meters outside

3. Which type of outdoor surface is there?



☐ Gravel



☐ Bricks



☐ Tiles



☐ Asphalt

Please provide
a photo

☐ Other

4. What type of inside surface is there?

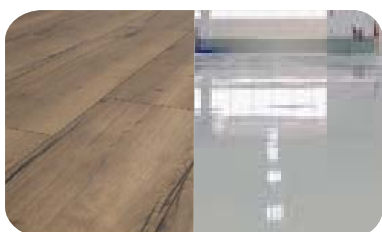

☐ Hard: wood, concrete, stone or laminate



☐ Soft: carpet or vinyl

Please provide
a photo

☐ Other

5. Are there any thresholds on the route to be covered?

- ☐ | Yes
☐ | No

If so: How high are these thresholds?

_____ mm

6. Is there a ramp? More information in the chapter [‘When to use a moving company’ on page 6.](#)

- ☐ | Yes
☐ | No, please go on to question 7

If so: provide the information here and fill in at least two of these variables:

Length of the ramp: _____ mm

Difference in height of the ramp: _____ mm

Slope of the ramp: _____ degrees

Is there a rotation in the hill?

- ☐ | Yes
☐ | No

If so: how big is this pivot space:

Length _____ mm

Width: _____ mm

7. How large is the narrowest passage? More information in chapter [‘Measuring the passageway’ on page 5.](#)

Height: _____ mm

Width: _____ mm

8. How large is the space for the narrowest passage? More information in chapter [‘Measuring out the route’ on page 4.](#)

Length: _____ mm

Width: _____ mm

9. Where will the machine be placed?

- ☐ | Ground floor
☐ | Other, that is: _____

10. Is there an elevator that the machine has to enter?

- ☐ | Yes
☐ | No

If so: How big is the elevator? (Also, be sure to measure the grips inside the elevator.)

Length: _____m

Width: _____m

Height: _____m

Weight limit: _____ kg

11. Are pallet trucks allowed inside and outside?

- ☐ | Yes
☐ | No

12. Are only specific pallet trucks allowed? With rubber wheels, for instance.

- ☐ | Yes
☐ | No

13. Is there a pallet truck available that we can use?

- ☐ | Yes
☐ | No

14. Is a forklift or stacker available that can carry at least 850 kg at 1100 mm?

- ☐ | Yes
☐ | No

15. Will a moving company be employed?

- ☐ | Yes
☐ | No

16. How many people can actively help with the placing?

17. Contact person and phone number

Afvinklijst voor de locatie

1. Is the correct fire extinguisher on hand? More info in the chapter ['Fire extinguishers' on page 10.](#)
☐ | Yes
☐ | No
2. Are there 2 type E or F electrical outlets within 2 meters of the machine?
More info in the chapter ['Electricity' on page 7.](#)
☐ | Yes
☐ | No
3. Is there at least 10 A per outlet available for the machine and peripheral equipment?
☐ | Yes
☐ | No
4. Is the space where the machine and extractor are located at least 85 m³? This is with regard to natural fresh air.
☐ | Yes
☐ | No
5. Is there a wall pass-through pipe present?
☐ | Yes, specifically Ø ____ mm
☐ | No, a BRM extractor is chosen
☐ | No, an in-house extraction system is chosen
6. Is a computer equipped with Windows 10 or later or MacOS X available? (An administrator account is required during installation.)
☐ | Yes
☐ | No