

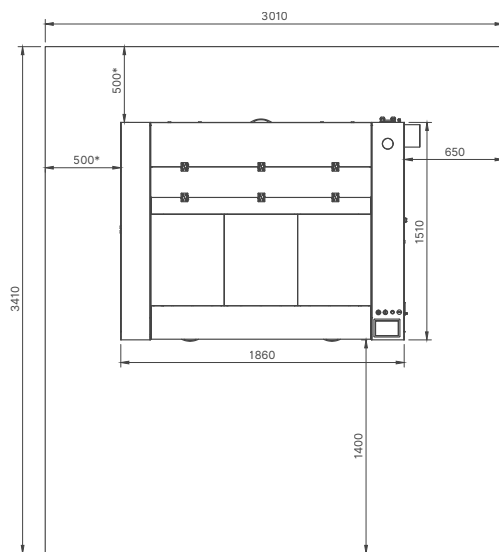

# Installation guide Slim 1300

This installation guide is provided to help you prepare for the delivery and installation of a BRM laser machine. You will find this information in more detail in the Delivery information pdf.



All dimensions are in mm

## Dimensions

\* May be 0 if the required free space can be created during maintenance or repair.

## Weight

- 350 kg

## Feet

- Quantity: 4 adjustable feet
- Surface area of foot:  $\varnothing$  80 mm

## Connecting the machine

### Electricity

Electrical load: 2x 1 ~ 230 VAC, 50 Hz, max. 2,3 kW (10 A) (including the standard peripheral equipment)

The machine has two plugs to provide power to the machine. The first plug is for the laser machine itself. The second plug is for the peripheral equipment, if you want to switch these on or off via the laser machine. You use these for the:

- Non-filtering fume extractor
- Air pump
- Water chiller

Both plugs are fused at 10 amps and cannot be connected to the same group as this would overload the electrical circuit.

Requirements for the power supply on site:

- Two grounded outlets. Type E or F
- Minimum of 10 amps left per outlet, minimum of 20 amps in total
- If you are using a BRM Extractor, please inquire about other requirements

## Exhaust

A correct extraction of fumes is necessary. At the back of the machine is a connection with an external diameter of 145 mm. A non-filtering fume extractor with 2 pieces of hose is supplied as standard.

It is also possible to use your own exhaust solution. Several machines are often connected to this. This can create dangerous situations if sparks or burning particles are released. This is why we recommend installing a spark arrester when using a proprietary extraction solution to which several machines are connected. This is an excellent measure to cover a small risk with large consequences. The required capacity for the Slim 1300 is 550 m<sup>3</sup> at 15 mbar.

## Fire extinguisher

We recommend a CO<sub>2</sub> extinguisher. This is the best solution for an electrical fire. CO<sub>2</sub> quickly and effectively expels oxygen and suffocates the fire. Furthermore, CO<sub>2</sub> is very clean and the chance of collateral damage is smaller.

## Air supply

The machine comes standard with an 135 W air pump. It is also possible to connect your own (compressed) air solution if you have chosen for the optional software-controlled air supply unit. This requires a minimum of 120 l/ minute at 8 bar and needs to be connected to a 8 mm push-in fitting.

## Computer

### Connection:

The machine can be connected with a USB 2.0 A connector (Windows only) or with a RJ45 UTP connector on 100 Mbit duplex.

- Maximum length of USB cable: 3 metres
- Connection via USB hub is not recommended
- Maximum length of network cable: 100 metres
- The network connection is not DHCP-compatible

### Minimal requirements:

- Windows 10 or later, MacOS X or later
- When installing the software, one-time admin rights are required

The following applies to every computer

- At least a 800 MHz processor
- At least 2 GB working memory
- At least 500 MB storage